

Installation Manual for TH-7281B Heating or Cooling Electronic Thermostat

PREPARATION: Before installing this thermostat, check your system wiring diagram. If your system is other than a low voltage heating or cooling system, please check with your local dealer. Do not connect both a Heat System and a Cool System to this thermostat.

NOTE: Leave this Manual with the homeowner for future reference.

1. Look for a location that has a constant temperature in the house and is not near the door entry or air conditioning outlet (see example on figure 1). Avoid sunny locations if possible.

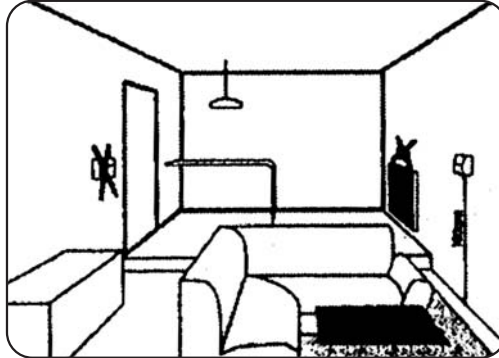

FIG. 1

2. **WARNING!!!** Turn off the main power switch before installing the thermostat.

3. Release the front cover by pressing a tab on the top of the front cover with a screwdriver (see figure 2). Remove the front cover with your hand holding both sides of the cover (see figure 3).

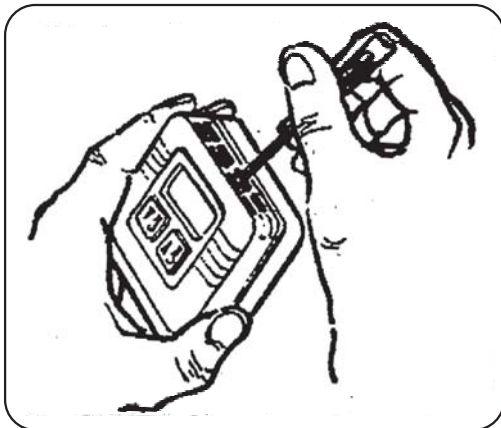

FIG. 2

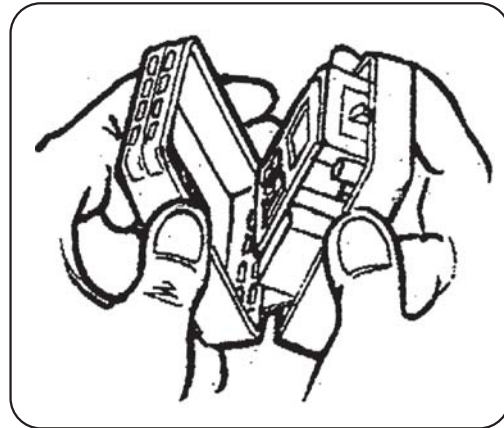
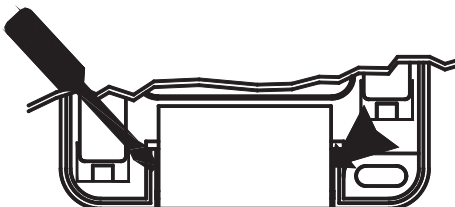

FIG. 3

4. Remove the cover to get access to the terminals (push a small flat screwdriver into the gap from the front and push the tab toward the center to open the cover). Pull the cover straight up (see figure 4).

5. Route the wires through the cutout in the base and mount the thermostat to the wall with two screws (see figure 5)."



shove screw driver into gap and push toward center to open plastic protection cover

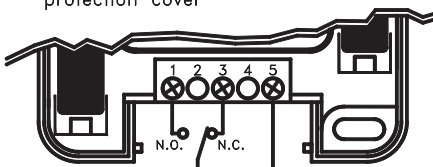

CONTACT RATING : 8A 250V

FIG. 4

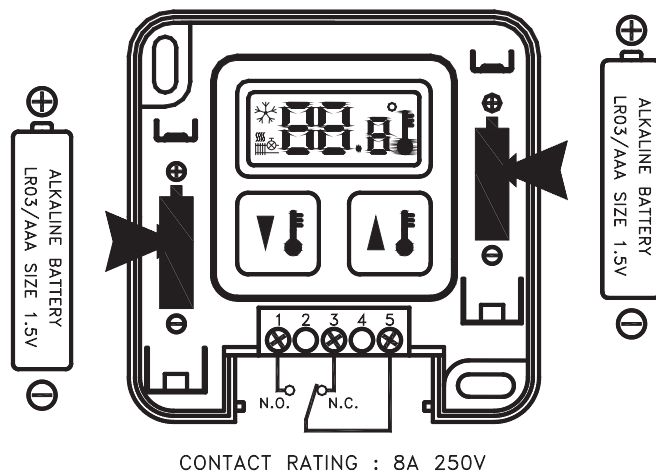

FIG. 5

6. Install the wires into the terminal block and tighten the screws (see figure 6).

Wiring Diagram (see FIG. 6):

TH-7281B FOR BATTERIES OPERATED MODEL



CONTACT RATING : 8A 250V

FIG. 6

Note:

- Terminal (1) N.O. contacts for Heating
- Terminal (3) N.C. contacts for Cooling
- Terminal (5) C = Common (one wire must be connected here)

7. Replace the terminal cover. Replace the front cover onto the base and make sure that the hooks on the base are locked with the front cover.



8. Install the two batteries.

9. Turn on the main power switch for operation.

Key Function:



System testing & Operating:

1. Press either ▼ or ▲ and LCD display will show a flashing temperature with "Heat On" symbol () and "Temperature Set" symbol ().

2. With a Heat System, and with the display still flashing, press the ▲ key to increase the setting to a temperature that is about 2 degrees warmer than the ambient temperature. Each press of the key will increase the setting by 1 degree F. Wait for 15 seconds until the LCD display stops flashing. If the system does not call for heat, wait 3 minutes for thermostat to respond (this is a safety feature to eliminate short cycling of any Heat Pump Compressor, etc.). The heat system should be operating. If you allow the ambient temperature to rise to this temperature setting, the "Heat On" symbol () will turn off and the heat system should turn off. If it does not turn off, check the wiring.

3. For a Cooling System, and with the display still flashing, press the ▼ key to decrease the setting to a temperature that is about 2 degrees colder than the ambient temperature. Each press of the key will decrease the setting by 1 degree F. Wait for 15 seconds until the LCD display stops flashing. If the system does not call for cooling, wait 3 minutes for thermostat to respond (this is a safety feature to eliminate short cycling of any A/C or Heat Pump Compressor, etc.). The cooling system should be operating. If you allow the ambient temperature to lower to this setting, the cooling system should turn off. If it does not, check the wiring.

4. With the display flashing, press again either ▼ or ▲ to set the desired temperature. Every press on ▲ will increase 1°C and every press on ▼ will decrease 1°C.

NOTE: If the display changes from indicating the "ambient temperature" to "Lo", replace the batteries with new AAA size batteries. Alkaline batteries are recommended.